

Camera Replacement G100

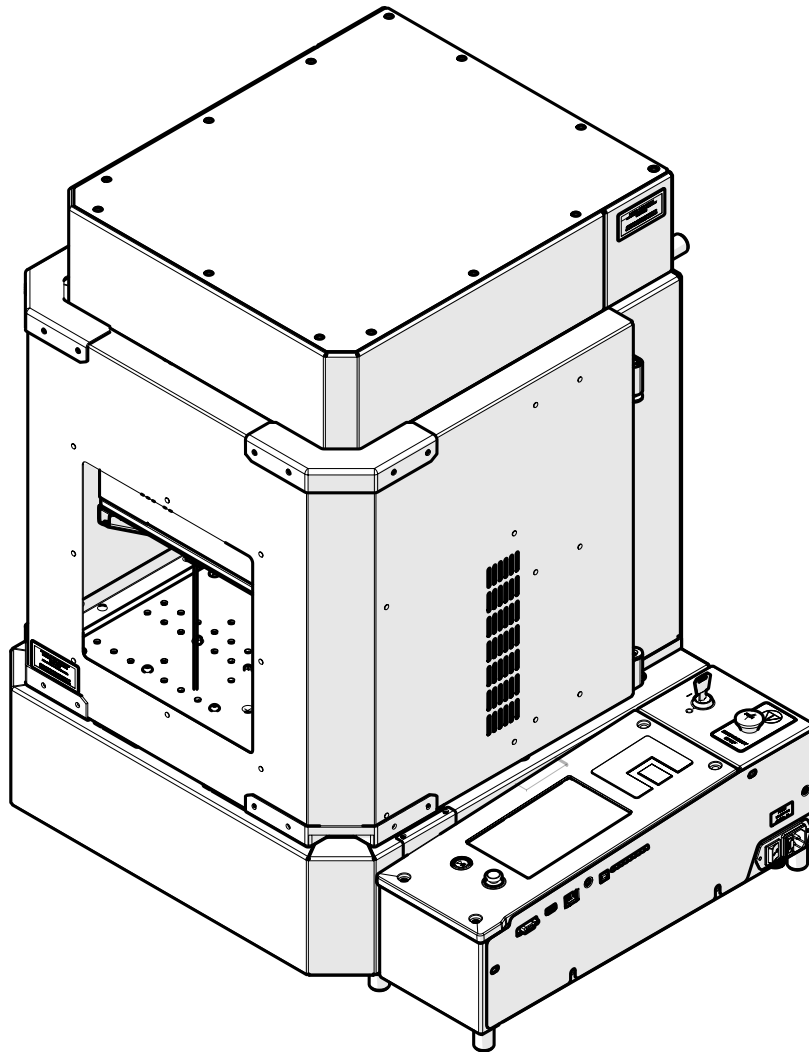

Parts Required

- GC0200 - Assy, Camera, Overhead, Galvo, F254
- GC0150 - Assy, Camera, Overhead, Galvo, F163

Tools Required

- T30 Torx Driver
- T10 Torx Driver

Camera Removal

1. Turn off

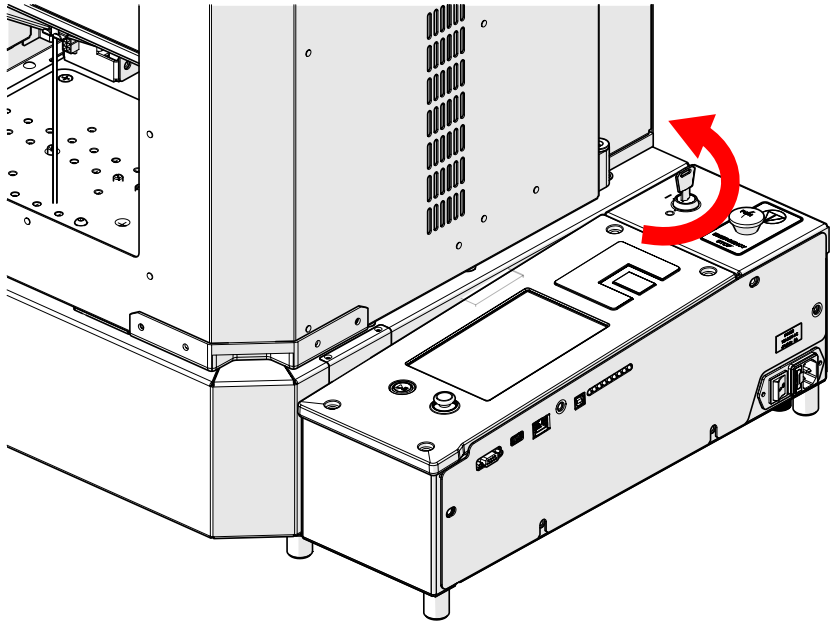

2. Disconnect from power

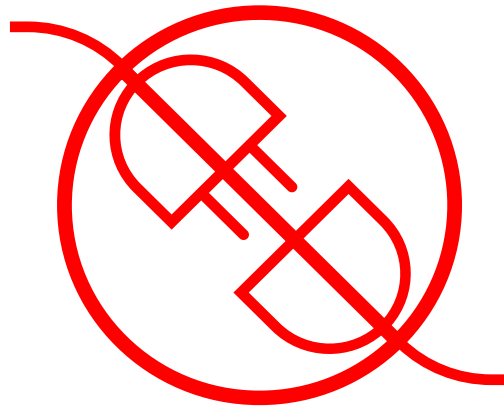

3. Loosen and remove

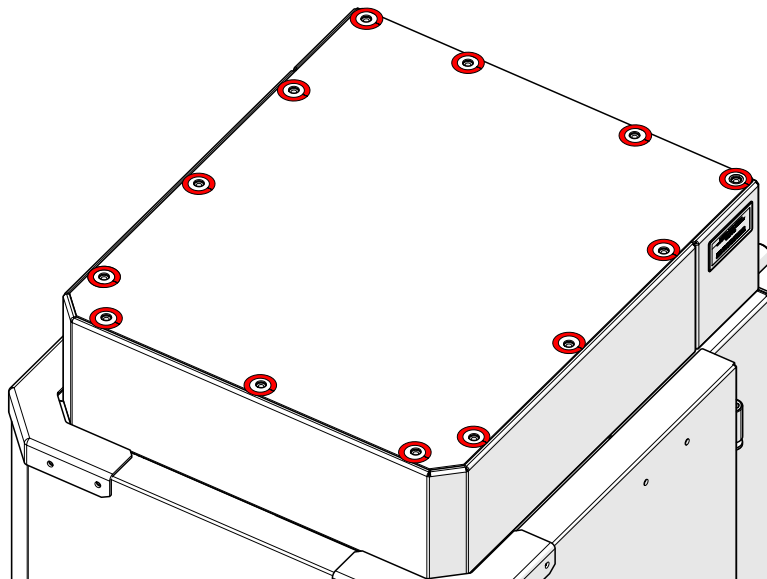

4. Remove cover

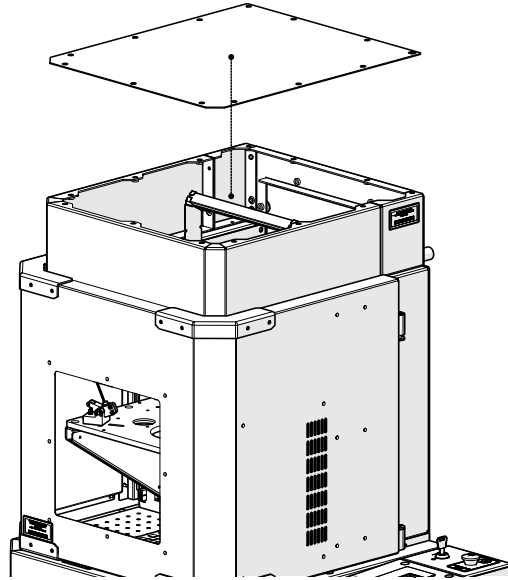

5. Loosen and remove

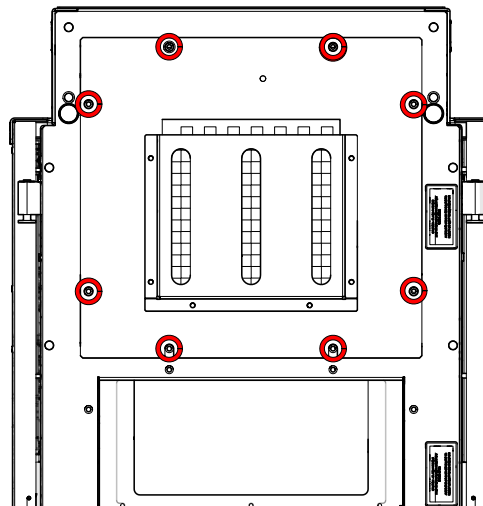

6. Remove cover

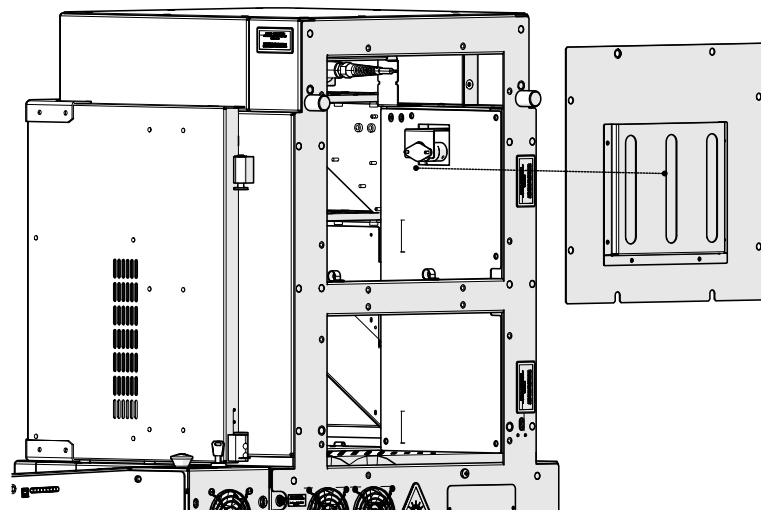

7. Disconnect USB

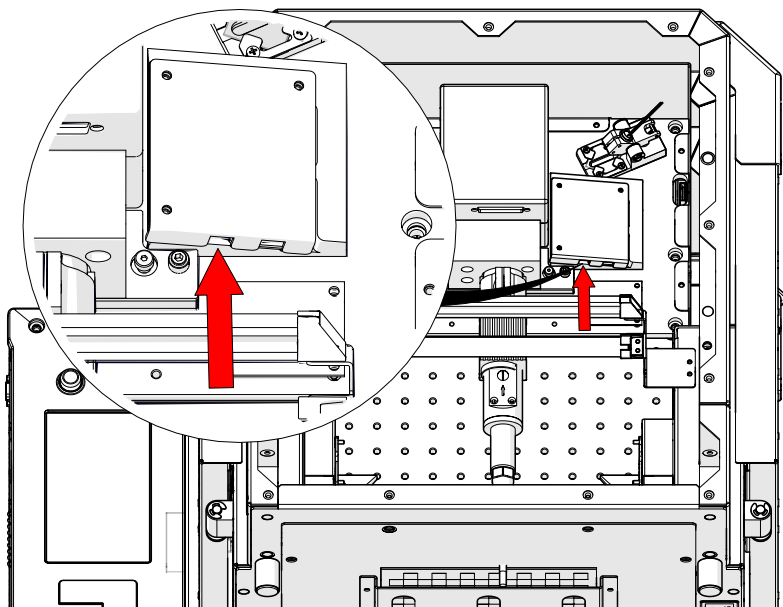

8. Loosen and remove

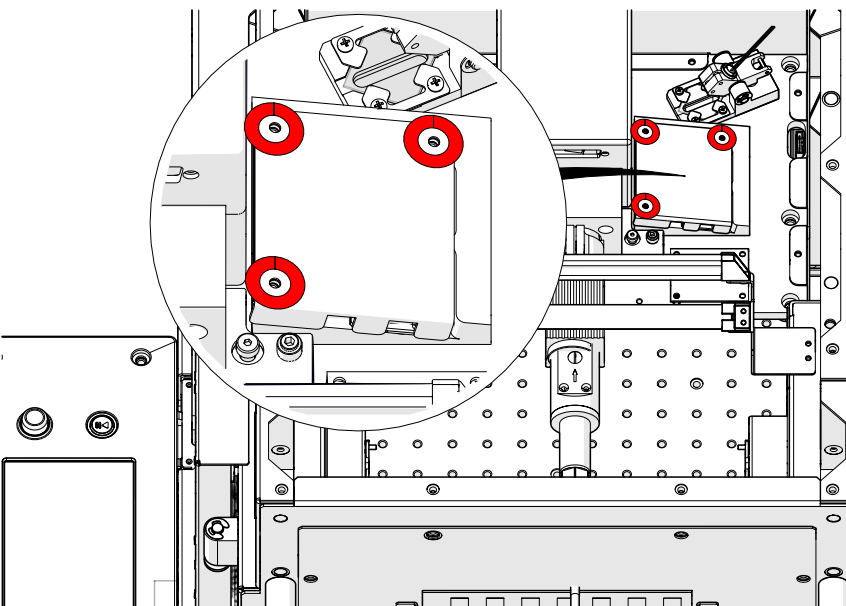

9. Remove cover

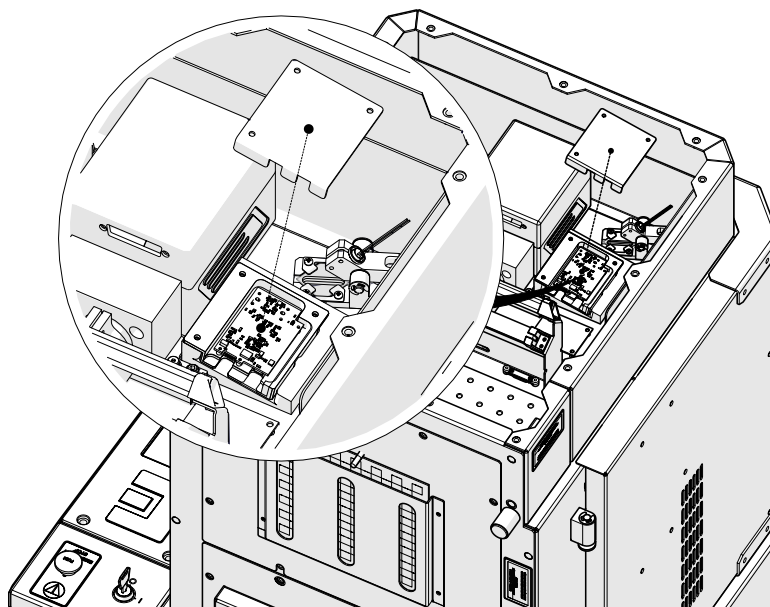

10. Remove camera assembly

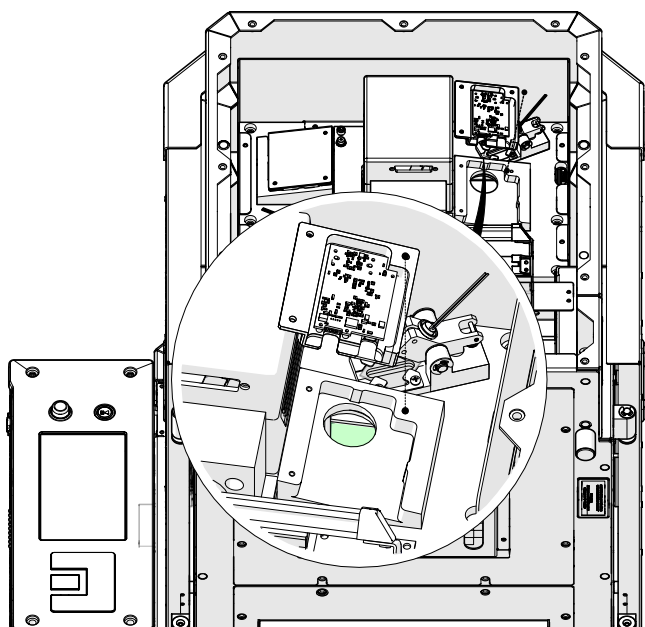

Camera Installation

1. Install camera

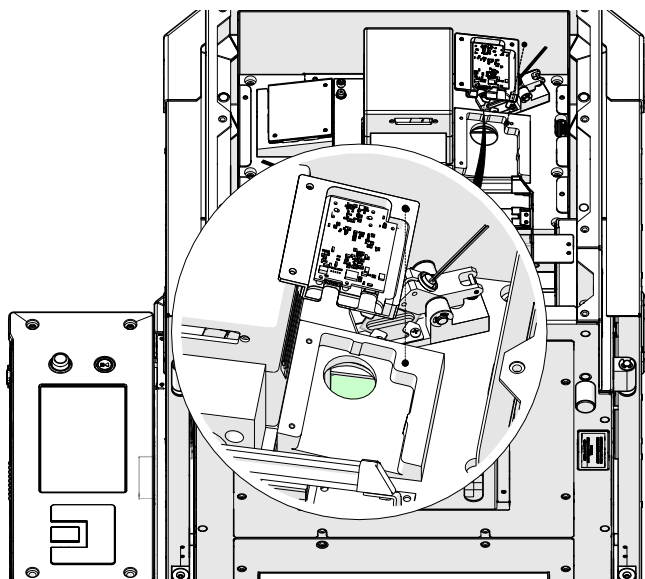

2. Install cover

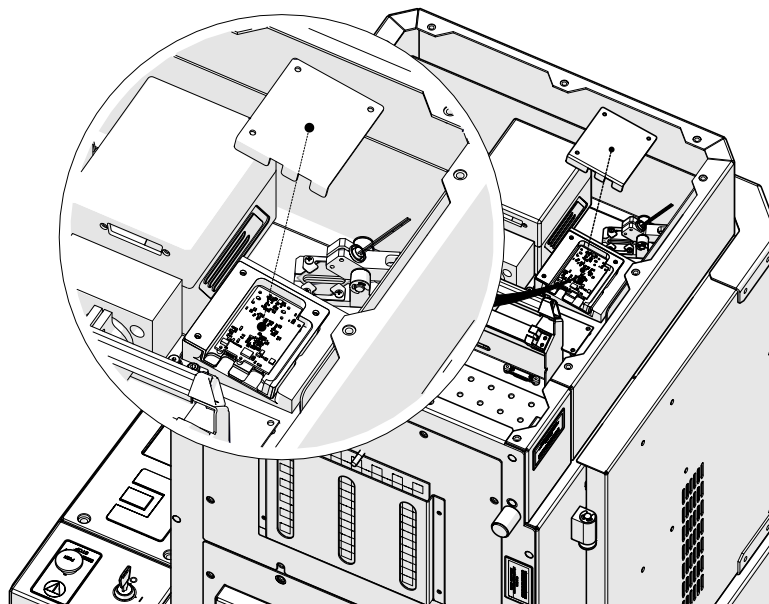

4. Install and tighten

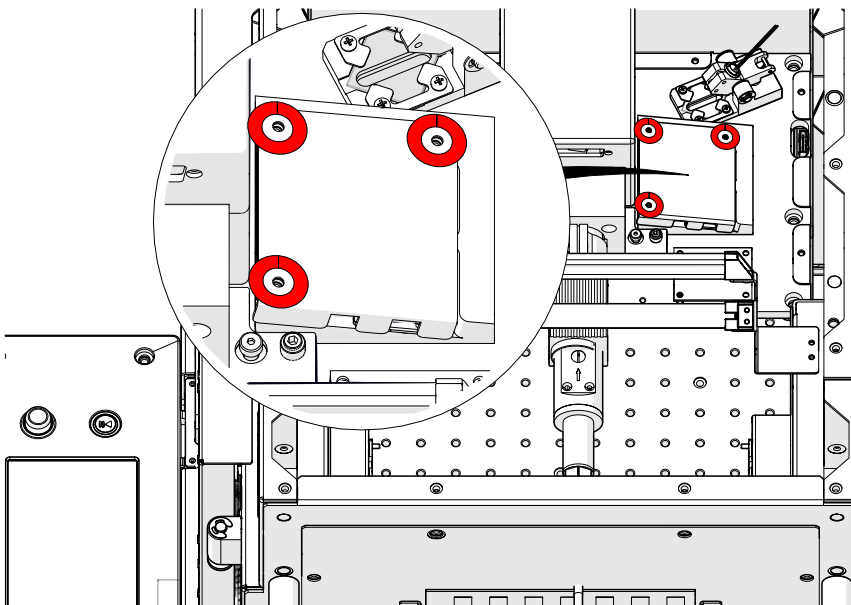

5. Connect USB

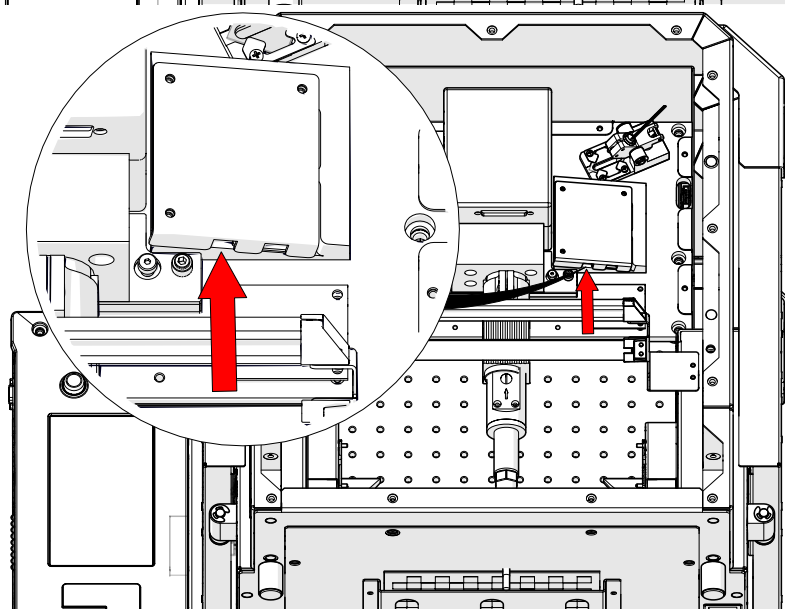

6. Install cover

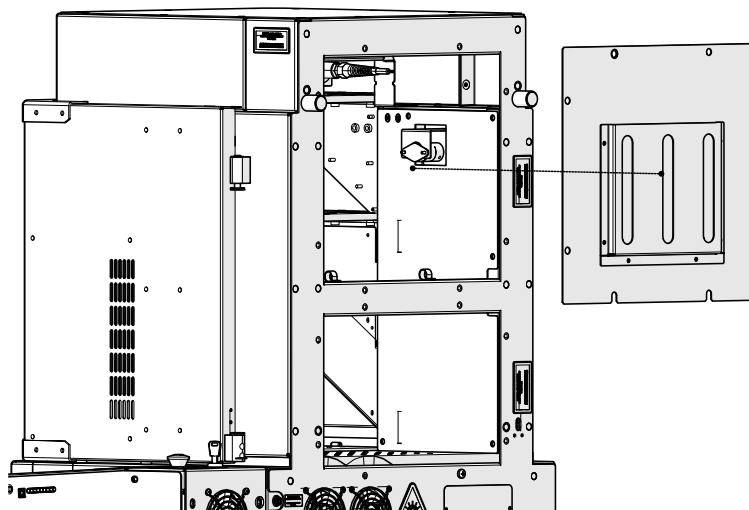

7. Install and tighten

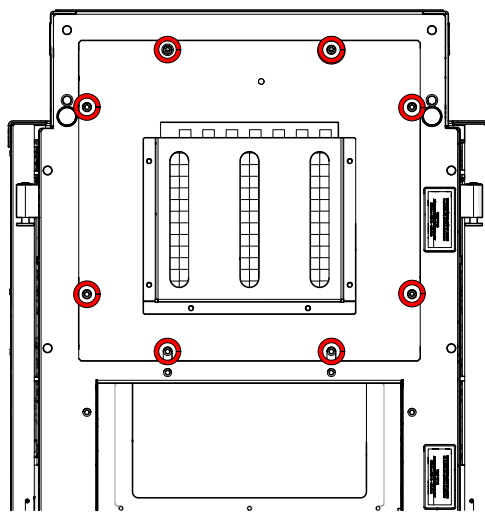

8. Install cover

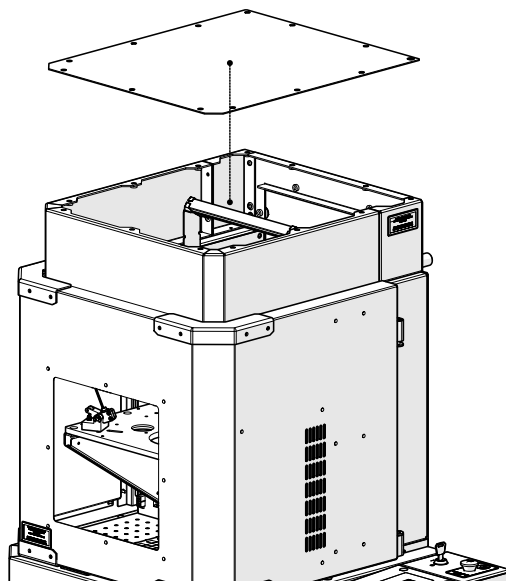

9. Install and tighten

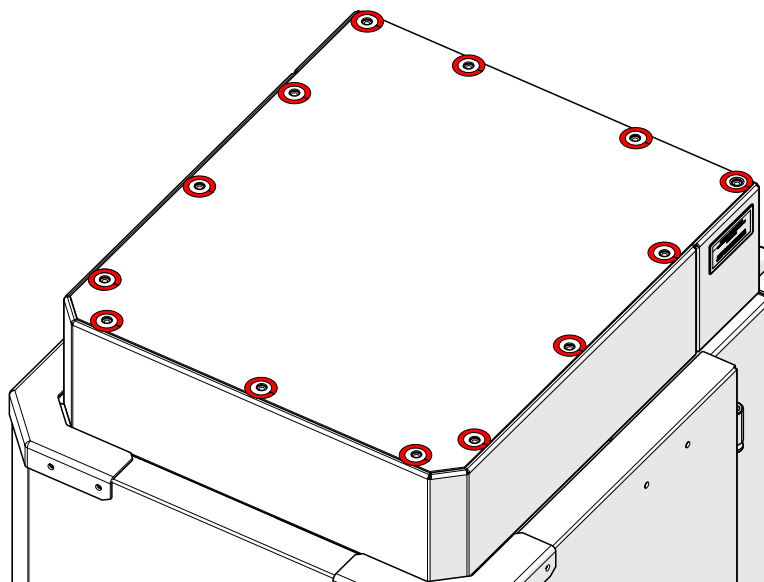

18000 - Camera Replacement

10. Connect to power

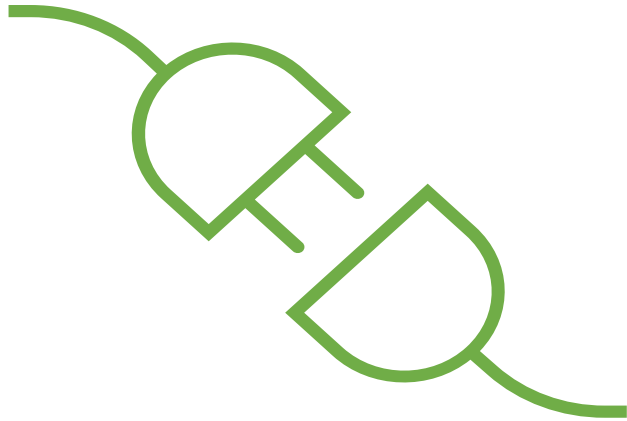

After replacing the camera assembly, the focus and camera calibrations must be completed.

If further assistance is needed please contact Epilog Laser Tech Support by phone at 303-215-9171, or by email at tech@epiloglaser.com