

## X-Axis Motor Replacement Fusion Edge 12, 24 & 36, Fusion Pro 24 & 36

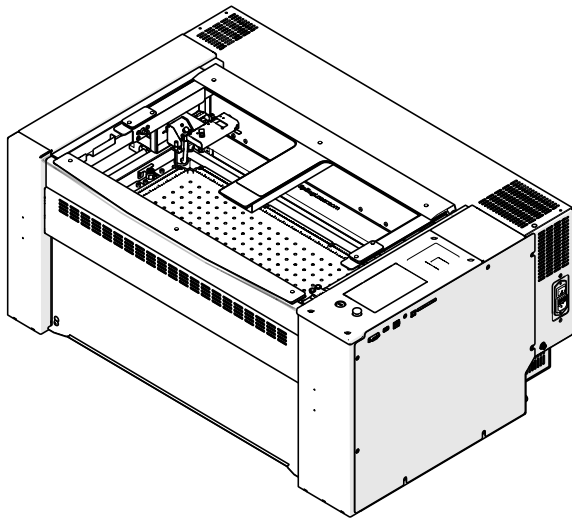

### Parts Required

For Edge Models

- LC0416 - Assy, Motor, Servo, X-Axis

For Pro Models

- LC0648 - Assy, Motor, Servo, X-Axis, High Speed

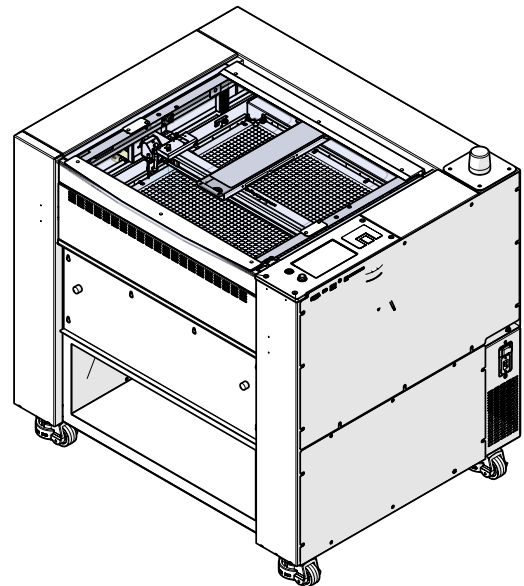

### Tools Required

- Phillips head screwdriver
- 5/32" Allen wrench
- 7/64" Allen wrench

# 17000 X-Axis Motor Replacement

## X-Axis Motor Replacement

### X-Axis Motor Removal

1. Turn off the engraver.
2. Disconnect engraver from power source.
3. Remove the right panel of the engraver:

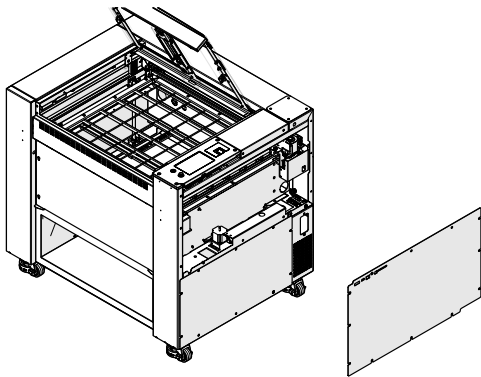

4. Manually move the x-axis assembly to the middle of the engraver:

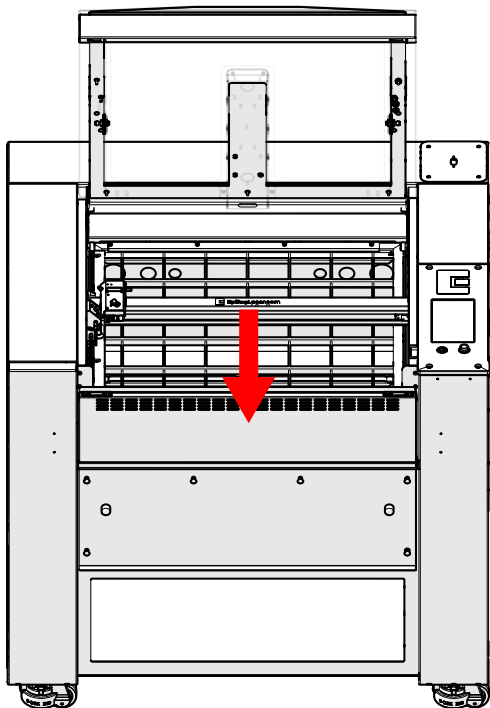

5. Loosen, but do not remove the four (4) Phillips head screws on the x-axis motor drive board cover:

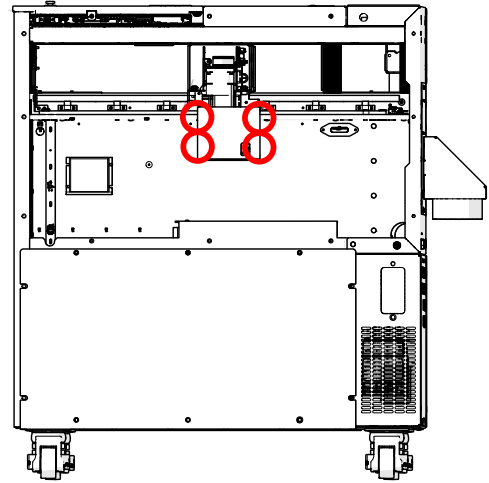

6. Remove the x-axis motor drive board cover:

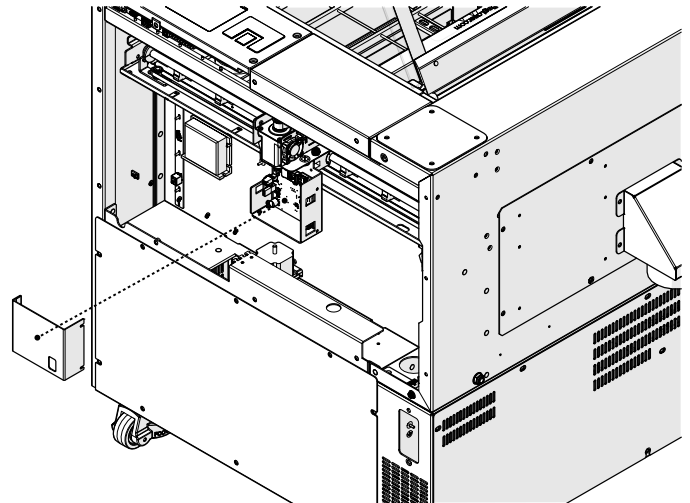

## RUNNING HEADER (MODEL AND PROCEDURE)

7. Disconnect the three (3) x-axis motor electrical harnesses from the x-axis motor drive board:

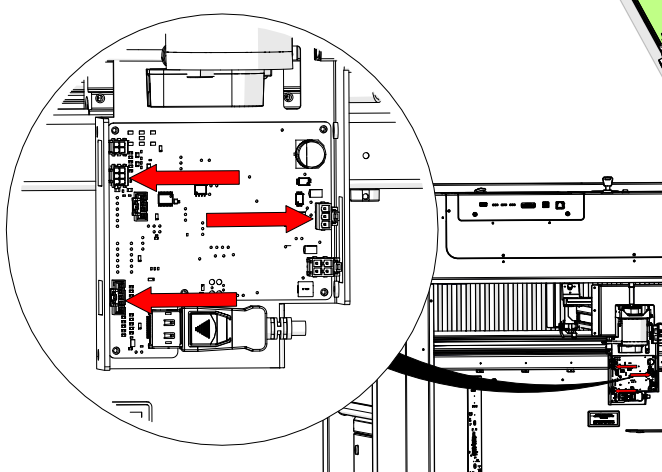

8. Loosen, but do not remove the four (4) 7/64" Allen screws that secure the x-axis motor to the x-axis assembly:

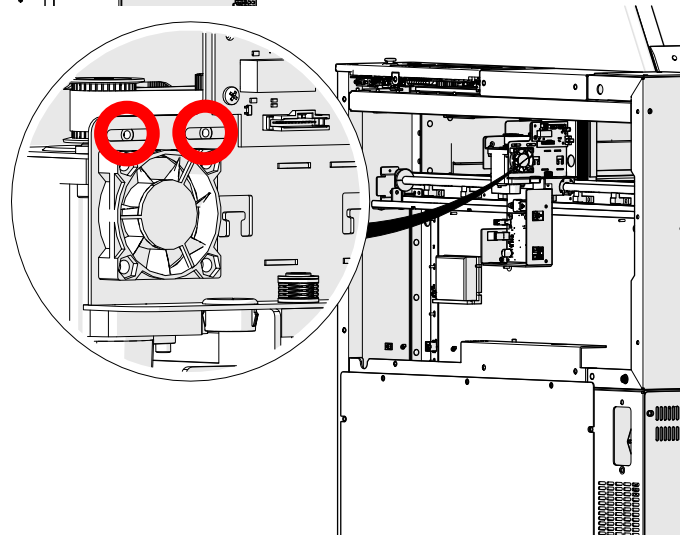
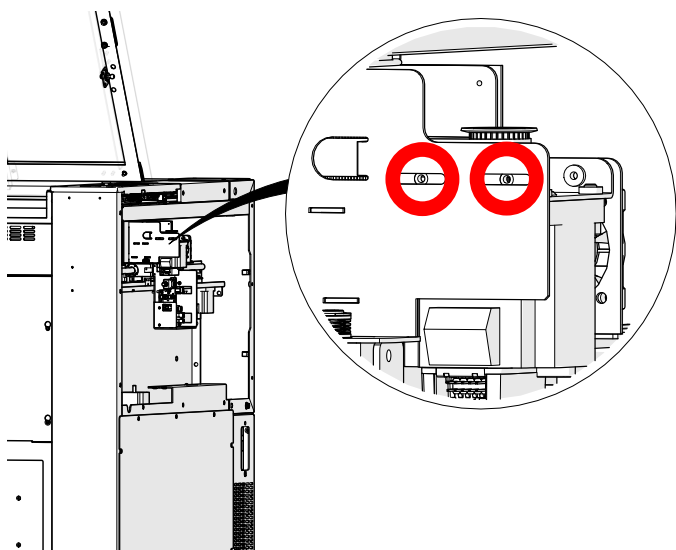

9. Loosen the 7/64" Allen screw on the reducer drive belt tensioner:

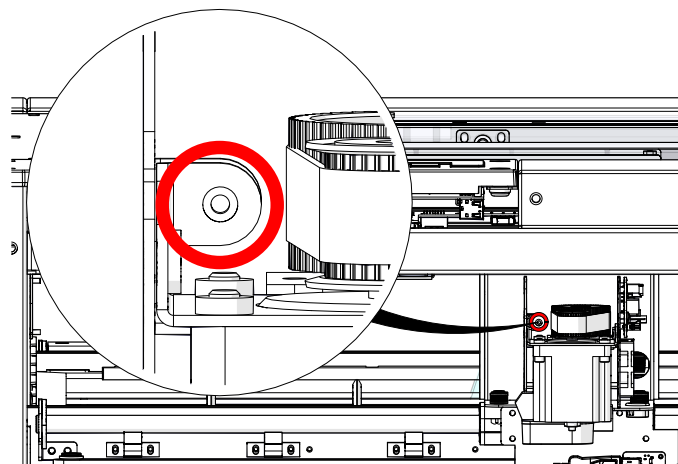

10. Remove the reducer drive belt:

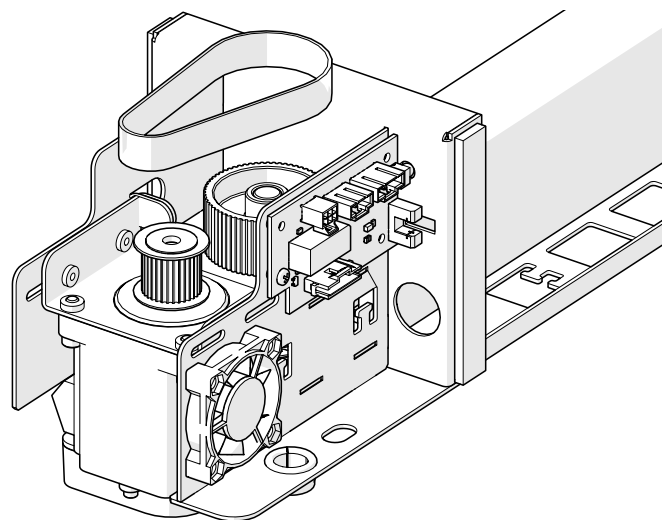

## 17000 X-Axis Motor Replacement

11. Remove the four (4) 7/64" Allen screws that secure the x-axis motor to the x-axis assembly:

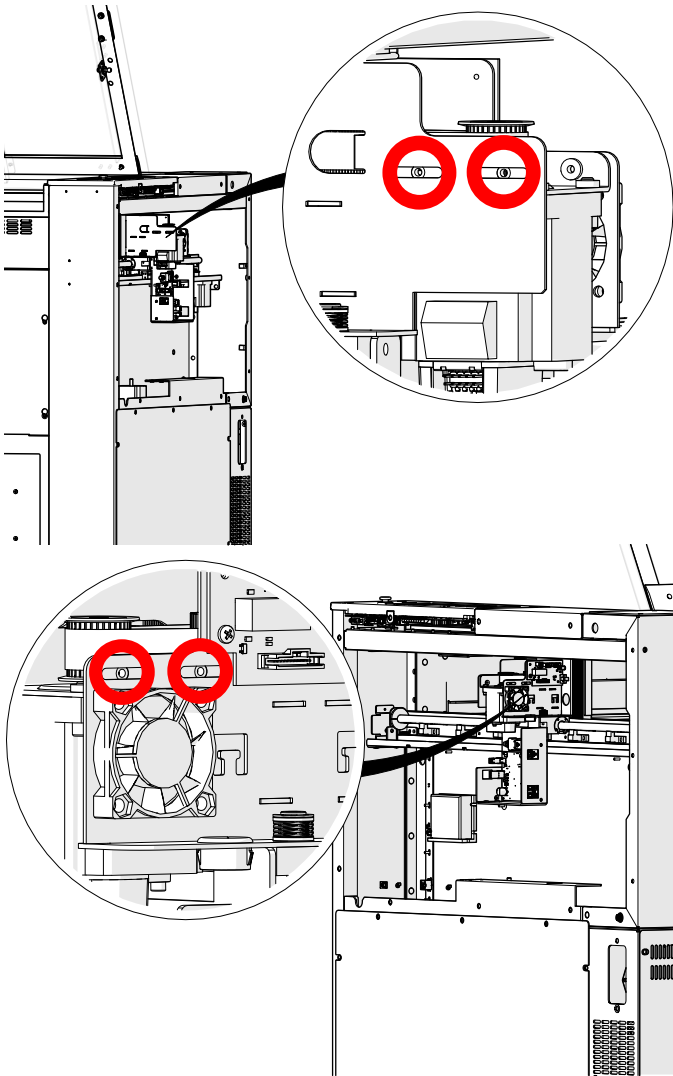

12. Remove the x-axis motor:

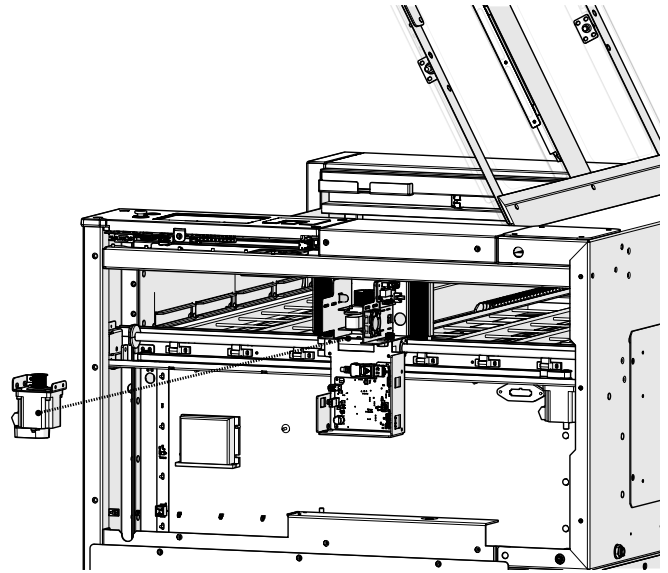

# RUNNING HEADER (MODEL AND PROCEDURE)

## X-Axis Motor Installation

1. Place the x-axis motor into the x-axis assembly:

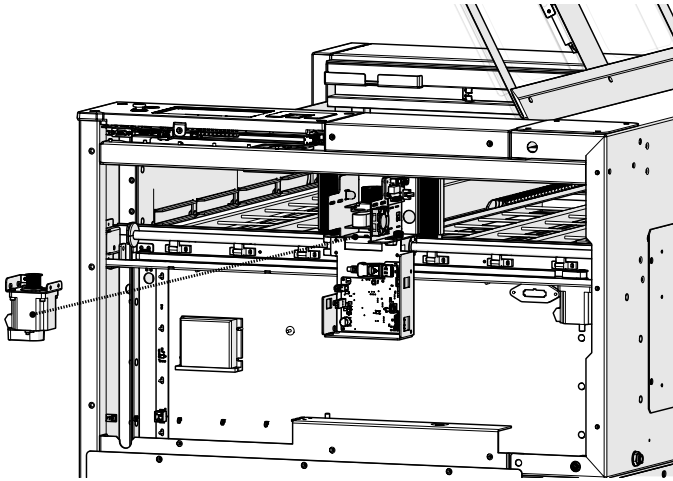

The x-axis encoder connection must face the front of the machine, as shown below. Any other orientation will prevent the machine from booting up correctly.

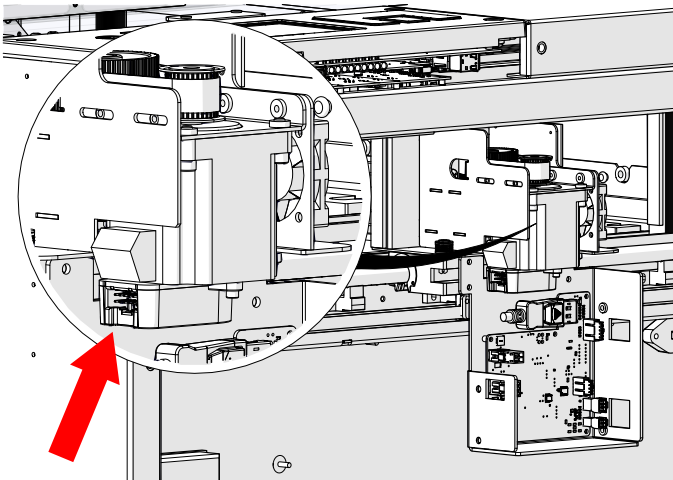

2. Install, but do not fully tighten the four (4) 7/64" Allen screws that secure the x-axis motor to the x-axis assembly:

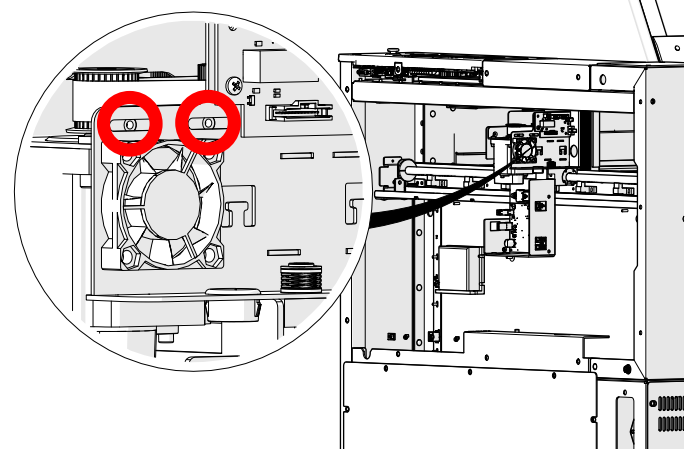
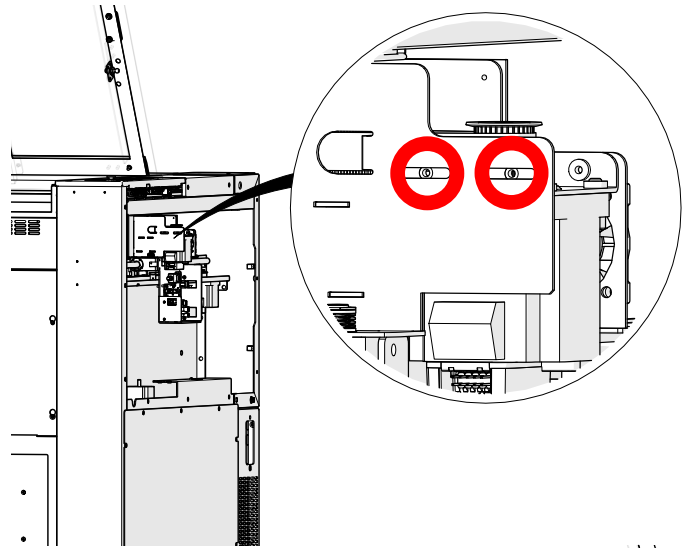

3. Install the x-axis reducer belt:

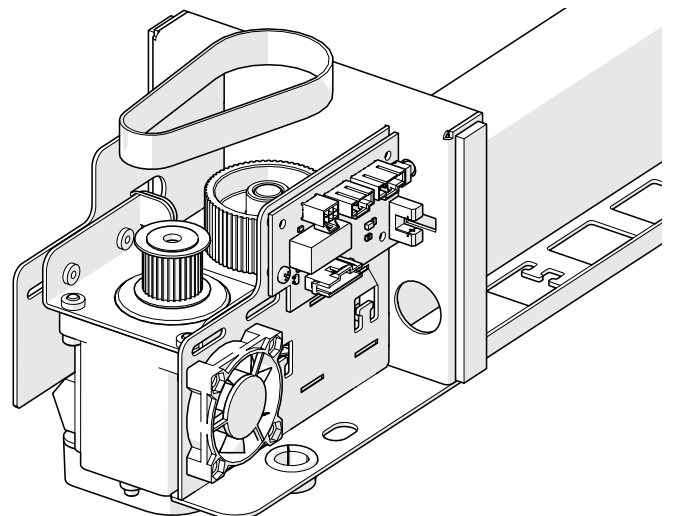

## 17000 X-Axis Motor Replacement

4. Tighten the 7/64" Allen screw on the reducer drive belt tensioner until the slack is removed from the reducer belt:

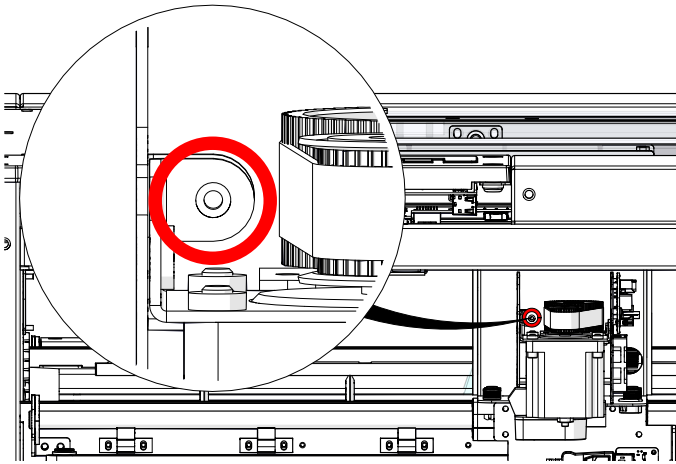

5. Tighten the four (4) 7/64" Allen screws that secure the x-axis motor to the x-axis assembly:

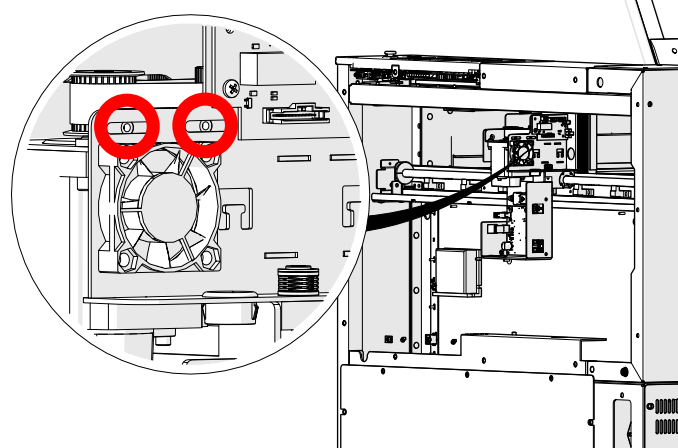
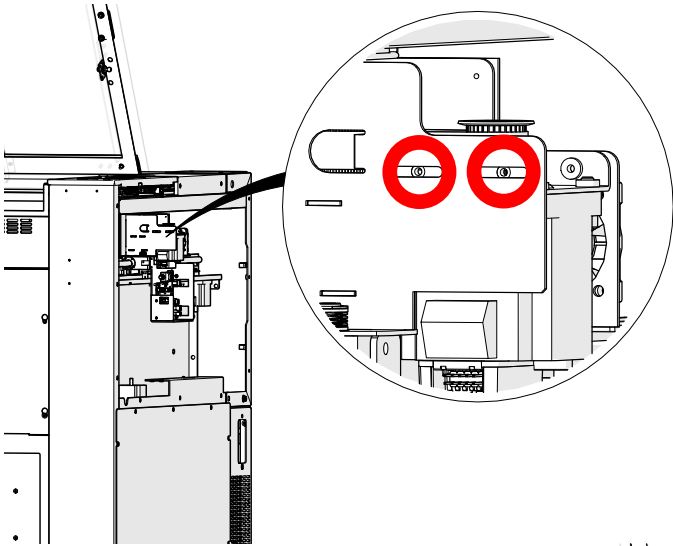

6. Connect the three (3) x-axis motor electrical harnesses to the x-axis motor drive board:

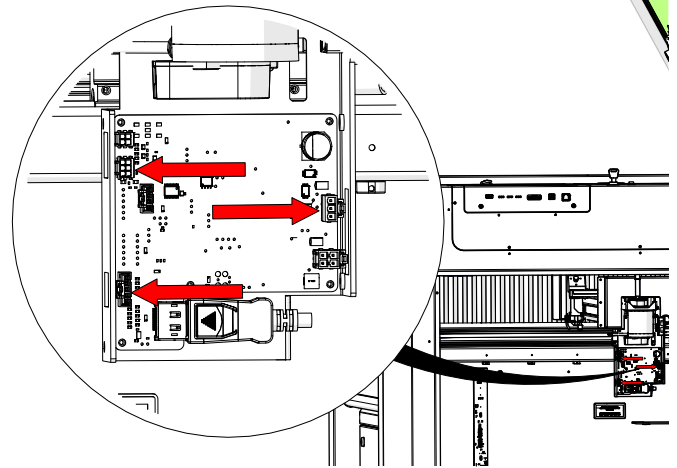

7. Install the x-axis motor drive board cover:

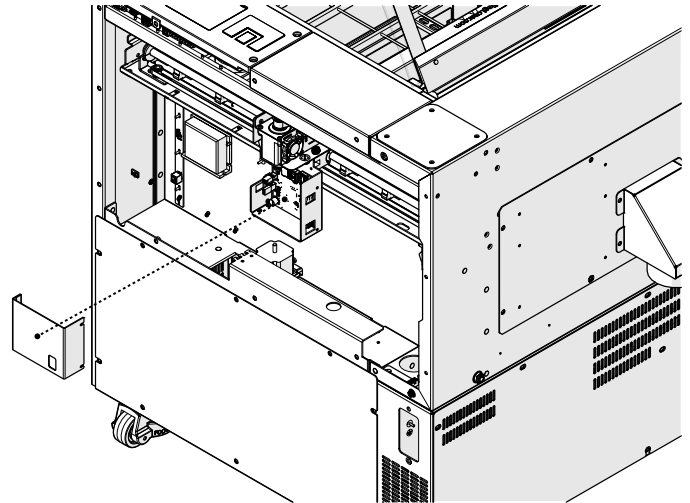

8. Tighten the four (4) Phillips head screws on the x-axis motor drive board cover:

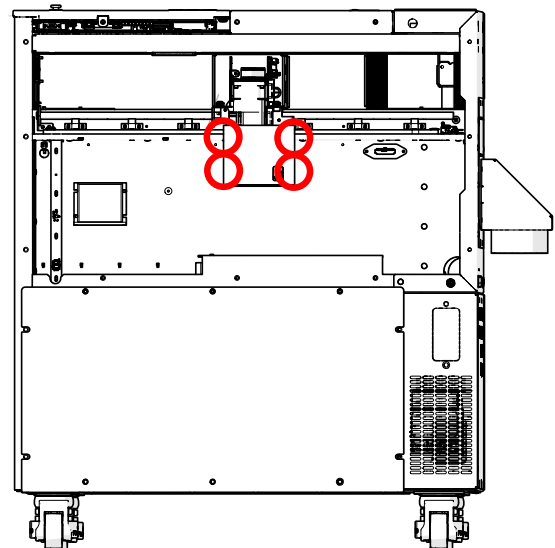

## RUNNING HEADER (MODEL AND PROCEDURE)

9. Replace the right side panel of the engraver.
10. Reconnect to power and turn on the engraver.

---

**To confirm that the motor has been installed correctly, use the diagnostic menu in the engraver to observe the x-axis motor RMS current. At idle, the RMS current should show as ~0.3-0.4A.**

---

If further assistance is required, please contact Epilog Laser Tech Support by phone at 303-215-9171, or by email at [tech@epiloglaser.com](mailto:tech@epiloglaser.com).