

X-Axis Air Assist (AA) Tubing Replacement Fusion Pro 32 & 48

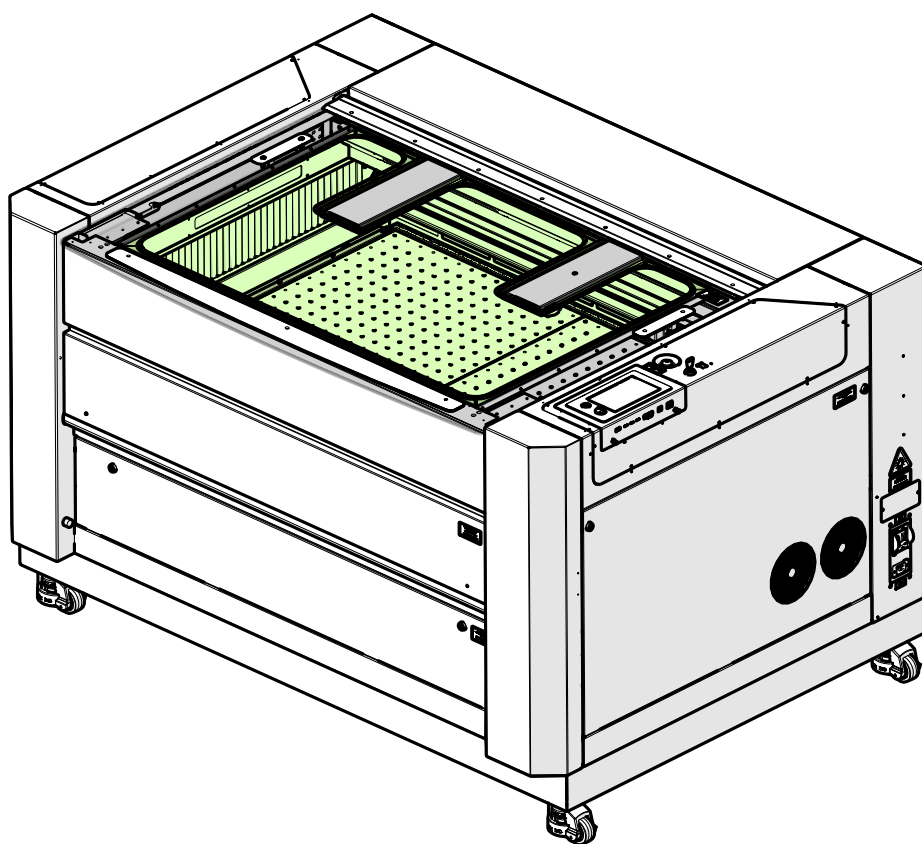

Parts Required

- LC0643 - Tubing, Air, Vinyl, 5/16"OD x 3/16"ID
 - Pro 48 - 6'
 - Pro 32 - 4.5'

Tools/Materials Required

- 5/32" Allen Wrench
- T7 Torx Driver
- Wire Cutters
- Cable Ties

X-Axis Air Assist (AA) Tubing Replacement

X-Axis AA Tubing Removal

1. Turn off the engraver.
2. Disconnect engraver from power source.
3. Remove the right panel of the engraver.
4. Remove the nine (9) Torx screws that secure the carriage assembly cover and remove the cover:

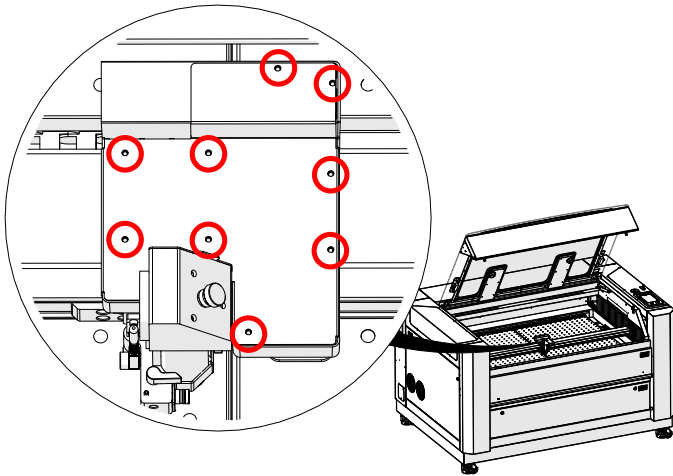

5. Remove the carriage cover:

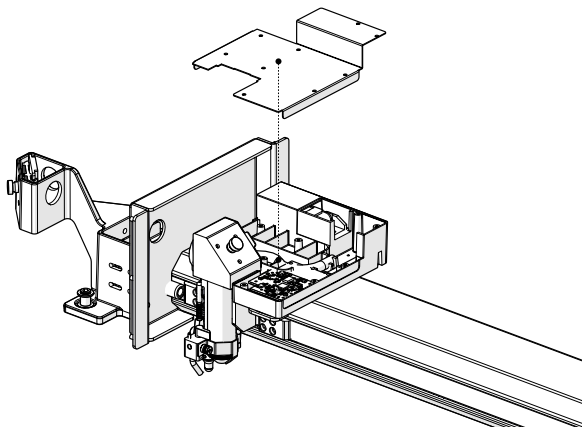

6. Disconnect the AA tubing from the connector on the carriage assembly:

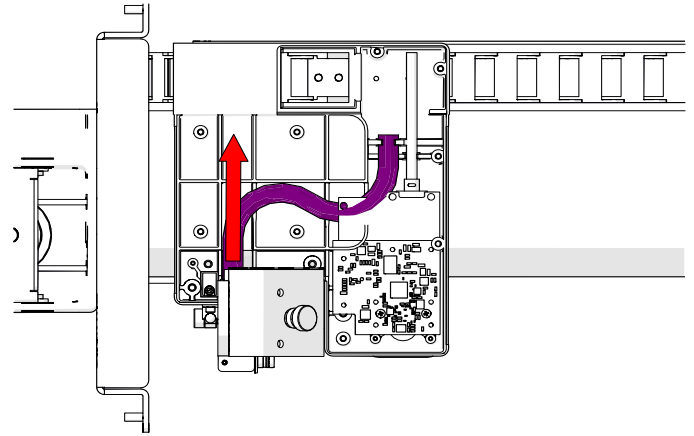

7. Disconnect the lens camera PCB USB cable:

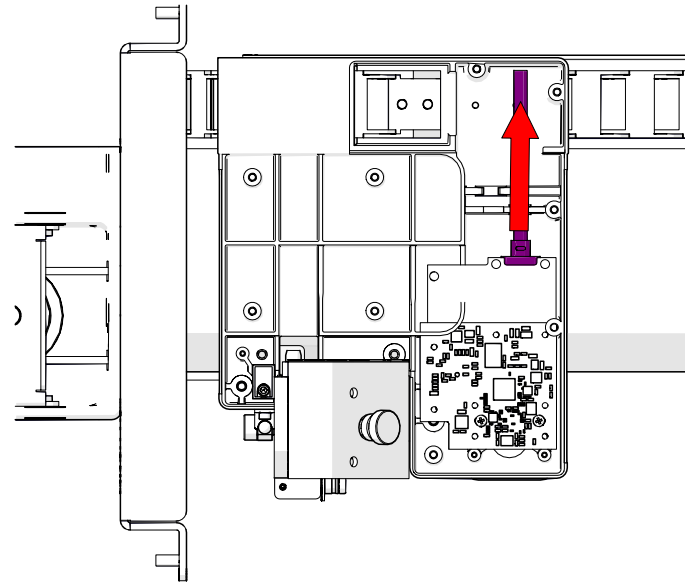

8. Loosen and remove the two (2) Phillips screws that secure the cable track to the rear of the x-axis assembly:

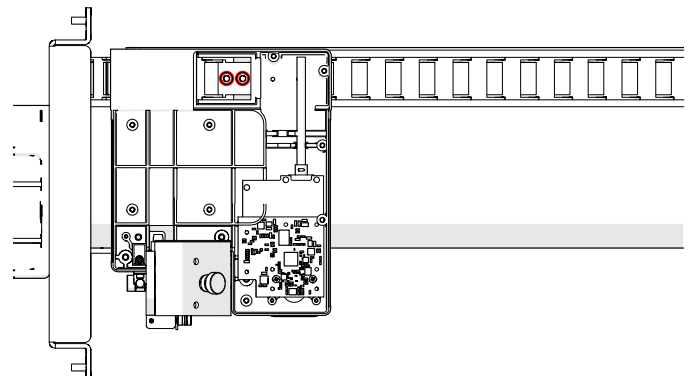

16000 - X-Axis AA Tubing Replacement

9. Pull the cable track to the left side of the machine to straighten it. This will make removing the AA tubing easier.
10. Pull the AA tubing towards the right side of the machine to remove it from the cable track, taking care not to remove the USB cable with it is also being replaced.

The AA tubing and carriage camera USB cable may be ziptied to the x-axis assembly in certain points. If this is the case, remove the zipties and replace them once the installation of the AA tubing is complete. Take care not to over-tighten the zipties.

11. Disconnect the AA tubing from the elbow connector at right side of the x-axis assembly:

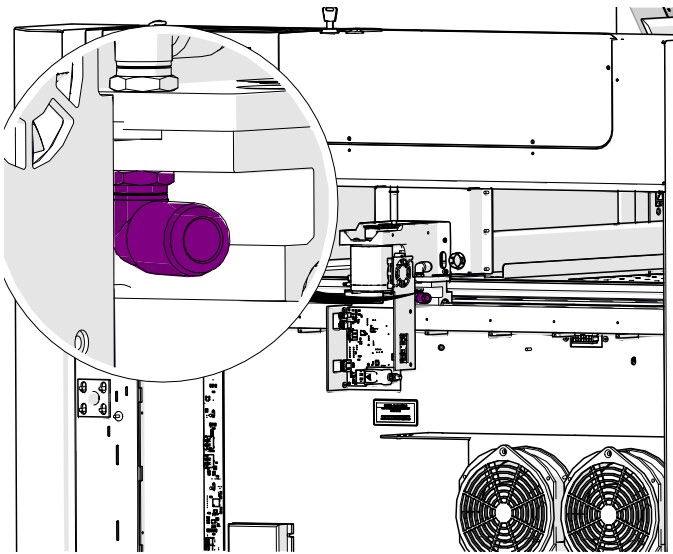

To remove the tubing, press the tubing into the fixture. Then, hold the orange retaining ring tight to the fixture, pull the AA tubing away from it.

12. Remove the AA tubing from the engraver.

X-Axis AA Tubing Installation

1. Connect the AA tubing to the elbow connector at right side of the x-axis assembly:

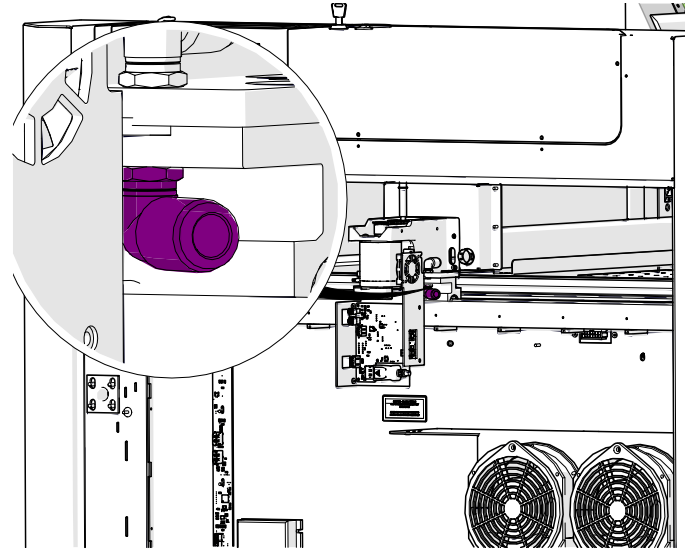

2. Route the AA tubing through the opening on the right side of the x-axis assembly.
3. Insert the AA tubing into the right side of the cable track and push it towards the left side.
4. Place the cable track into position and tighten the two (2) Phillips screws that secure the cable track to the rear of the x-axis assembly:

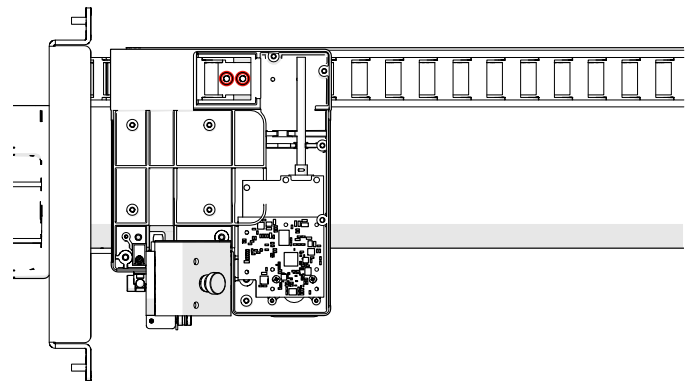

16000 - X-Axis AA Tubing Replacement

4. Connect the camera board USB cable:

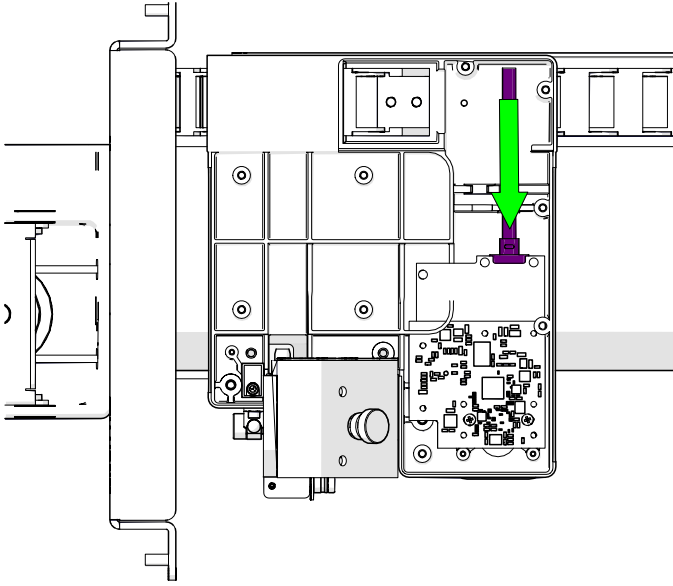

5. Connect the AA tubing to the connector on the carriage assembly:

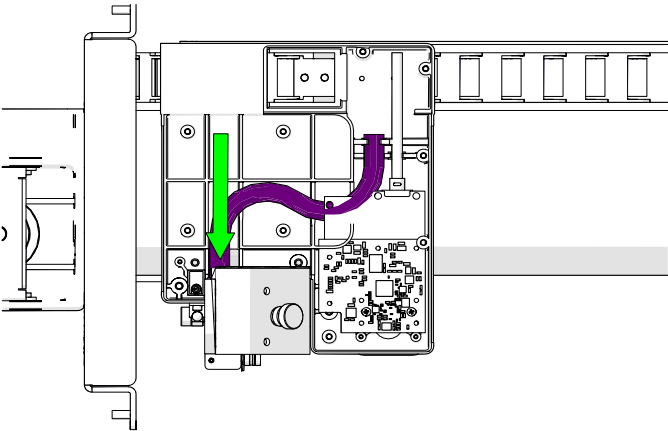

6. Install the carriage cover:

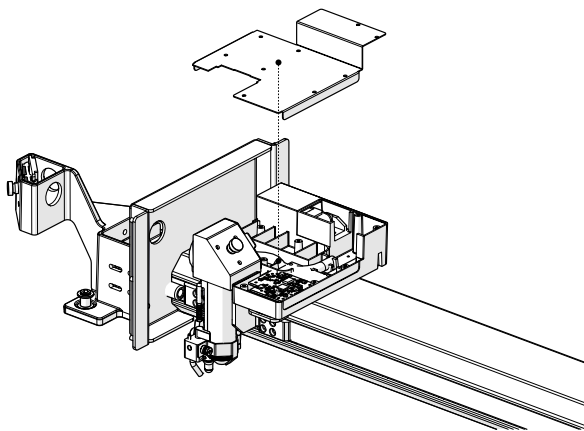

7. Install and tighten the nine (9) Torx screws on the carriage cover:

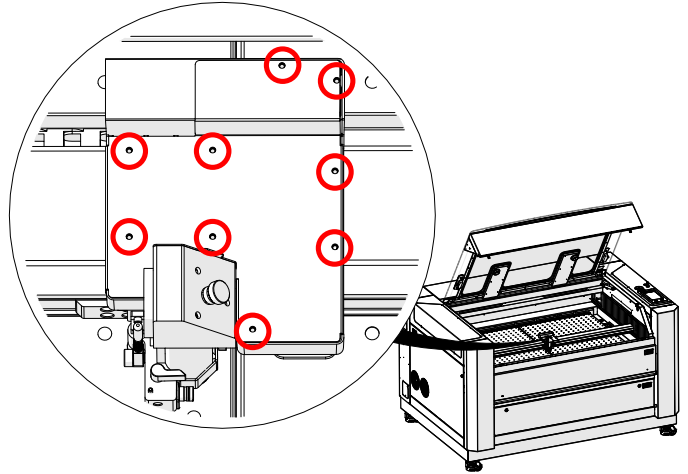

8. Replace the right panel of the engraver.

If further assistance is required, contact Epilog Laser Technical Support by phone at 303-215-9171, or by email at tech@epiloglaser.com.